

PARTICIPATING SCHOOLS

International School of Bangkok

Jakarta International School

Kuala Lumpur International School

Manila International School

Singapore American School

Taipei American School

IASAS
CULTURAL
CONVENTION
2005

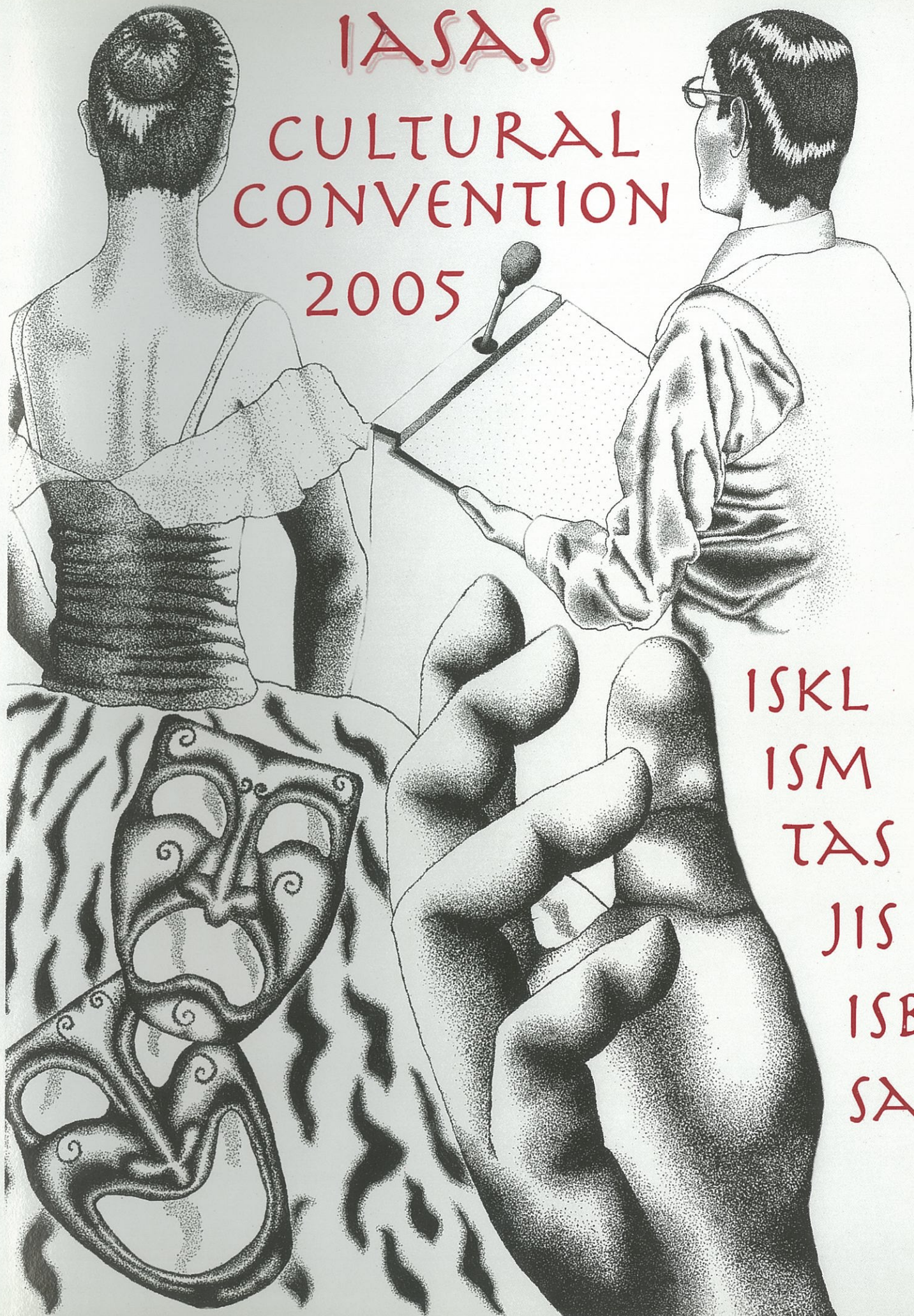

ISKL
ISM
TAS
JIS
ISB
SAS

SINGAPORE

MARCH 10-12



SINGAPORE AMERICAN SCHOOL

Welcomes You
To The
23rd Annual

JASAS CULTURAL CONVENTION
2005

March 10-12, 2005
SINGAPORE



IASAS CULTURAL CONVENTION 2005

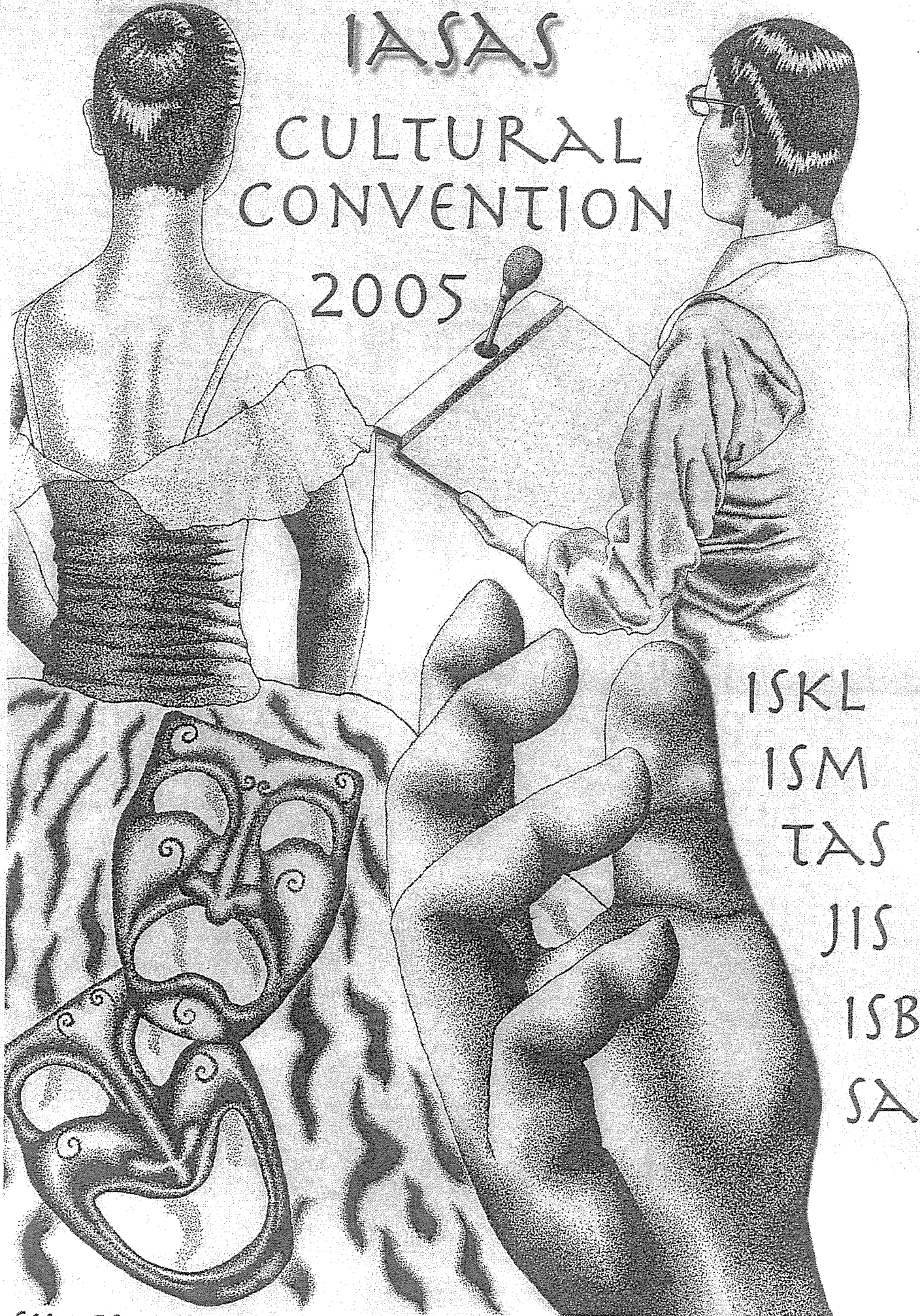

ISKL
ISM
TAS
JIS
ISB
SAS

SINGAPORE

MARCH 10-12

Cultural Convention Personnel

| | |
|---|---|
| Convention Directors | <i>Mr. Brian Combes Ms. Mimi Molchan</i> |
| Theatre/Technical Director | <i>Mrs. Paula Silverman</i> |
| Theatre/Technical Coordinator | <i>Mr. Paul Koebnick</i> |
| Activities Secretary | <i>Mrs. Zaiton Jaafar</i> |
| Dance Site Director | <i>Mrs. Dawn Betts</i> |
| Drama Site Director | <i>Mrs. Susan Murray</i> |
| Debate Site Director | <i>Mr. Roy Tomlinson</i> |
| Forensics Site Director | <i>Mr. Mark Guggisberg</i> |
| Judges Coordinator | <i>Mr. Dave Norcott</i> |
| Results Team Manager | <i>Mr. Duane Melsom</i> |
| Student Volunteer Coordinators | <i>Mrs. Martha Began Mrs. Shelley Griffin</i> |
| Student Assistants | <i>SAS Students</i> |
| Website Coordinator | <i>Ms. Judy Ridgeway</i> |
| Cultural Convention 2005 Logo Design..... | <i>Ms. McKinley Sheerin</i> |

Important Numbers

High School Principal

Mr. Paul Chmelik 6762-5142 (home) 9822-4458 (h/p)

High School Deputy Principal

Mr. Dave Norcott 6884-0304 (home) 9137-9101 (h/p)

Convention Directors

Ms. Mimi Molchan 6219-5906 (home) 9636-1574 (h/p)

Mr. Brian Combes 6476-4247 (home) 9457-0105 (h/p)

Sponsors & Advisors Hotel

Orchard Parade Hotel..... 6737-1133

General Information

Activities/Athletics Office: Glass office located on the 1st floor near the track.

High School Cafeteria: Located on the first floor.

Advisors' Meeting/Dinner: H301 on Wednesday, March 9th at 7:15pm.

Nurses Office: M122

Booster Booth: Located on second floor by High School Office.

Hours: Thursday and Friday only: 7:30am - 3:15pm.

Banquet: HS Cafeteria on Saturday, March 12th from 6:10pm - 7:30pm.

T-Shirts: Available on third floor foyer on Thursday and Friday. \$10.00

Convention Headquarters: H310

Advisors' Hospitality Room: H301

Judges' Room: H332.

Team Photo Schedule: Wednesday, March 9th upon arrival.

Drama Rooms: S105, Drama Theatre and Auditorium.

Dance Rooms: S200, S201, Theatre Studio and Auditorium.

Forensics/Debate Rooms: H325, H326, H327, H328, H329, H330.

Extemporaneous Prep Room: H212

Team Rooms: ISB: H424, JIS: H423, ISKL: H422,
ISM: H421, SAS: H420, TAS: H419

Computer Use: Located in Room H403 on fourth floor; left side of elevator. Cultural Convention guest access:

Windows Login: Cultural05

Password: IASAS

Please Note:

Remember that the Team Rooms are regular classrooms and should be kept neat and clean. Do not leave valuables unattended.

Arrival

Wednesday, March 9, 2005

| SCHOOL | FLIGHT / TIME | PICK-UP AT SAS |
|---------------|----------------------|-----------------------|
| ISM | PR 503 / 12:00 NOON | 3:30 PM |
| JIS | SQ 153 / 12:10 PM | 3:30 PM |
| ISKL | BY BUS / 5:00 PM | 5:15 PM |
| ISB | CX 712 / 3:20 PM | 5:15 PM |
| TAS | CX 735 / 5:40 PM | 7:30 PM |

Departure

Sunday, March 13, 2005

| SCHOOL | FLIGHT / TIME | DROP-OFF AT SAS |
|---------------|----------------------|------------------------|
| TAS | CX 736 / 10:10 AM | 7:00AM |
| ISKL | BY BUS / 9:00 AM | 8:45 AM |
| ISM | PR 505 / 1:00 PM | 10:00 AM |
| JIS | SQ 158 / 1:30 PM | 10:30 AM |
| ISB | CX 712 / 1:45PM | 10:45 AM |

TRANSPORT SCHEDULE

PICK UP / DROP OFF POINTS

WEDNESDAY, MARCH 9, 2005

Host families are asked to pick-up and transport their guests from SAS to their home. Please see "Arrival and Departure schedule" that is enclosed.

THURSDAY, MARCH 10, 2005

6:45am Buses **LEAVE** American Club and Holland Village.
Delegates transported to SAS, Woodlands.

10:30pm Students **ARRIVE** at American Club and Holland Village by bus from SAS, Woodlands.

FRIDAY, MARCH 11, 2005

6:45am Buses **LEAVE** American Club and Holland Village.
Delegates transported to SAS, Woodlands.

10:15pm Students **ARRIVE** at American Club and Holland Village by bus from SAS, Woodlands.

SATURDAY, MARCH 12, 2005

8:00am Buses **LEAVE** American Club and Holland Village.
Delegates transported to SAS, Woodlands.

9:15am Buses **LEAVE** American Club and Holland Village.
Delegates transported to SAS, Woodlands.

12:00noon Buses **LEAVE** American Club and Holland Village.
Delegates transported to SAS, Woodlands.

9:15pm Students **ARRIVE** at American Club and Holland Village by bus from SAS, Woodlands.

SUNDAY, MARCH 13, 2005

Host families are asked to drop-off their guests at SAS. Please see attached "Arrival and Departure schedule" that is enclosed.



CULTURAL CONVENTION 2005



Event Descriptions

DANCE

Each school presents a 16-20 minutes originally choreographed dance. Dancers choose a theme, choreography movement, select music, design costumes set and lighting and of course, rehearse. It is the goal of each dance team to establish a rapport with their audience such that whatever they dance, if they dance it well, the audience will recognize the quality of their work.

Dancers engage in a critique session following the performances, which are designed to draw out both details of the performance and the process. Dance is a non-competitive element of the Cultural Convention. Additionally, dancers engage in a number of workshops, which aim to explore different forms of dance and movement. These workshops often feature elements of traditional dance forms associated with the culture of the host country.

DRAMA

Each school presents a one-act play or a cutting from a full-length play not to exceed 45 minutes. The play may be serious or humorous, but it cannot be musical. The maximum size of the cast is 30, though most plays involve a much smaller cast. Actors, like dancers, may also participate in the other events such as forensics and debate.

Because of the demands of the theatre facilities created by twelve drama and dance performances, each school is encouraged to minimize set, props and technical effects. This results in simple sets, and often very creative use of props and lighting. As a result, IASAS Cultural Convention drama performances place an emphasis on the acting skill of the performers.

The accompanying synopsis for each school gives a brief overview of each of the drama productions to be performed. As in the dance section, actors are given the opportunity to critique each performance and participate in a variety of workshops. Drama is also non-competitive.

DEBATE

Each school must enter two debate teams consisting of two persons each. One of the two-member teams is designated as the "A" team, considered to be the stronger of the two, while the other is designated as the "B" team. Prior to the convention, all of the IASAS schools are given a list of possible topics. A ballot is taken and the topic with the most votes is designated as the topic for the convention. This year the debate topic is:

Resolved:

"SOCIAL EQUITY IS MORE IMPORTANT THAN ECONOMIC GROWTH"

IASAS Cultural Convention conducts a Lincoln-Douglas form of debate. Lincoln-Douglas (LD), named after the seven famous debates conducted in the United States in 1858, debates about a question of VALUE rather than a policy. For this reason LD is often referred to as Value Debate. Teams are prepared to debate either on the affirmative or the negative side. There are five preliminary rounds with each team debating as the affirmative and the negative two or three times. Teams are then selected for the semifinals on the basis of win-loss records. The winners of the semifinal round will advance to the final round. All of the finalists and semifinalists receive medals, while the championship team is awarded the IASAS debate traveling plaque.

FORENSICS

Forensics is the term used to describe the four speaking events that along with debate form the competitive elements of the Cultural Convention. During the convention each speaker is identified by a number and must participate in a minimum of three rounds. In these preliminary rounds each speaker is adjudicated by three judges, and on the basis of ranking achieved in each preliminary round, a group of six speakers per event advances to the finals. Certificates of Excellence are awarded to each finalist, while the top three speakers receive medals. The champion school is awarded the traveling plaque, which they keep until the following convention.

EXTEMPORANEOUS SPEAKING

Each contestant draws two topics for each round and then selects one. The contestant will have 30 minutes to prepare a speech of between 5-7 minutes in length. Source materials are derived from periodicals, magazines and other current event articles and must be provided by the contestant. Extemporaneous speakers specialize in current events and are skilled at creating speeches that explore world issues. The speaker is judged 70% on the content (adequacy of the introduction and the effectiveness of the speech construction and conclusion) and 30% on the delivery.

IMPROMPTU SPEAKING

Impromptu speaking requires speakers to be quick, flexible, eloquent, and entertaining. Two topics are presented to each speaker and after choosing one they have one minute to briefly outline a speech of between 3-5 minutes in length. During the rounds it is very interesting to hear the different styles of speeches and the different slants given to the topics. As with extemporaneous speaking, the speaker is judged on the adequacy of the introduction, the effectiveness of the speech's construction and conclusion, as well as the delivery of the speech. The evaluation is weighted 60% for content and 40% for delivery.

ORAL INTERPRETATION

Oral Interpretation is the skill of bringing to life the essence of a selected reading of a poem or prose through the use of the voice. During the reading the speaker is required to make visual contact with the script at least once per page. Costumes, make-up and lighting are not permitted. In Oral Interpretation the performance focuses on:

- ❖ the word being read
- ❖ the thematic significance and character development being conveyed through the voice
- ❖ containing and controlling facial and emotional expressions;
- ❖ movement of the head and shoulders (hand, leg, and foot movements are not allowed)

Each presentation lasts between 5-7 minutes. The adjudication is judged: 60% for delivery, 20% for interpretation, 15% for overall effectiveness and 5% for the introduction.

ORIGINAL ORATORY

Speakers in this category develop a persuasive speech around a topic in which they have an interest. Original Oratory requires the speakers to determine and research a topic, and to write and deliver a speech of 5-7 minutes in length. The speech must be an original piece of work and contain no more than 150 words of quoted material. During the presentation the speaker must maintain periodic eye contact with the text and with the audience.

The key element in Original Oratory is the concept of persuasion. While the speeches can be on a serious topic, they do not have to be serious. The speech may deal with a problem, propose solutions, alert the audience to a potential danger, strengthen dedication to an accepted cause, or eulogize a person.

Each speech is evaluated using weighting of 65% for content and 35% for delivery.

Audience Guidelines for Cultural Convention

Unless you are competing in a forensics or debate event, participating in a dance or drama workshop, or having some type of rehearsal, all CC participants are strongly encouraged to watch all forensics and debate events. Correspondingly, all debate and forensics participants are required to attend each drama and dance performance throughout the convention. Below are a few guidelines, which audience members need to keep in mind:

- ❖ Do not enter a room during a speech. Wait politely outside the room until the speaker has finished, then enter. Please cooperate with the door guards. They are there to ensure that the rules of the convention are upheld and that nothing occurs to disturb the presentation.
- ❖ Please be an appreciative audience. Remember how difficult it is to speak in front of a group. Be polite by not making distracting noises or movements.
- ❖ Entering the theatre downstairs in the auditorium after a performance has begun is not permitted. You must go upstairs to the balcony and the door guards will be able to assist you in entering. Please do be quiet, a performance is going on after all.

In the event that you are watching Impromptu, be aware that you can enter the room between speakers, but cannot exit the room until all speakers have spoken. In Impromptu Speaking the topics are secret and once you enter a room you must remain until the entire round has been completed.

JASAS Champions: Forensics & Debate

ORAL INTERPRETATION

| YEAR | NAME | SCHOOL |
|------|----------------------------------|-------------|
| 1993 | SRIMANT PANDA | JIS |
| 1994 | KARISHMA VASWANI | JIS |
| 1995 | KEVIN WATTS | JIS |
| 1996 | UNKNOWN | |
| 1997 | AKSHAY SATEESH | ISKL |
| 1998 | JOHANNA CUNNINGHAM | JIS |
| 1999 | IAN GRIFFITHS | ISKL |
| 2000 | DANIELS ROBERTS | JIS |
| 2001 | AUSTIN FARWELL | ISM |
| 2002 | CHRIS CHMELIK & BEVERLY JONES | SAS ISKL |
| 2003 | ROSANNA HYLAND | TAS |
| 2004 | CHRIS CHMELIK | SAS |

IMPROMPTU SPEAKING

| YEAR | NAME | SCHOOL |
|------|----------------------------------|--------|
| 1993 | UNKNOWN | |
| 1994 | YANTI ADDY | JIS |
| 1995 | ROBIN ADDY | JIS |
| 1996 | ODETTE LIENAU | JIS |
| 1997 | BEATRICE RECIO | ISM |
| 1998 | CYNTHIA BONDOC | ISM |
| 1999 | CYNTHIA BONDOC | ISM |
| 2000 | HANNAH PRITCHETT | JIS |
| 2001 | DINUSHI WIJEWARDENA & NOOR ZAIDI | ISM |
| 2002 | RAHUL NANDKISHORE | JIS |
| 2003 | PAOLO YAP | ISM |
| 2004 | RAHUL NANDKISHORE | JIS |

DEBATE

| YEAR | NAME | SCHOOL |
|------|------------------------------|--------|
| 1995 | R. ADDY / J.M. SULLIVAN | JIS |
| 1996 | D. CAMPBELL / S. MOHANDAS | SAS |
| 1997 | C. O'GORMAN / H. PAN | SAS |
| 1998 | H. PAN / A. SRIDHARAN | SAS |
| 1999 | A. BHARGAVA / T. SIEDELL | ISB |
| 2000 | C. CHYAU / S. WU | TAS |
| 2001 | P. CHATTERJEE / P. BHAGNANI | JIS |
| 2002 | P. GAGOOMAL / R. MASCARENHAS | ISM |
| 2003 | M. ORGILL / C. GROSS | ISKL |
| 2004 | S. TANG / S. TRAIN | SAS |

ORIGINAL ORATORY

| YEAR | NAME | SCHOOL |
|------|-------------------------------------|------------|
| 1990 | JOHN VOIGHTMAN | TAS |
| 1991 | SABRINA HAQUE | ISKL |
| 1992 | CAMILLE FUNK | TAS |
| 1993 | MALAIKKA HIJJAS | ISKL |
| 1994 | JEAN MARIE SULLIVAN | JIS |
| 1995 | BARBARA TSAI | TAS |
| 1996 | GRACE SU | TAS |
| 1997 | NIKHITA NAINAI | TAS |
| 1998 | JU-LIE LEE | SAS |
| 1999 | ELAINE WANG & NICOLE REICHENBACH | TAS ISM |
| 2000 | ALEX YATES | ISM |
| 2001 | JESSICA ISKANDAR | JIS |
| 2002 | ANYA VENTURA | TAS |
| 2003 | PAOLO YAP | ISM |
| 2004 | YI WEN LOOI | ISKL |

EXTEMPORANEOUS SPEAKING

| YEAR | NAME | SCHOOL |
|------|--|------------|
| 1993 | UNKNOWN | |
| 1994 | ROBIN ADDY | JIS |
| 1995 | ROBIN ADDY | JIS |
| 1996 | SIDDHARTH MOHANDAS | SAS |
| 1997 | UMUR TUNCER | JIS |
| 1998 | VIDHYA BALASUBRAMANIAN | JIS |
| 1999 | VICTORIEN WU | TAS |
| 2000 | MONIQUE MOL | JIS |
| 2001 | MING SIEN CHOONG | JIS |
| 2002 | JOSE MARTI CAMPOS & ROHAN MASCARENHAS | ISM ISM |
| 2003 | ROHAN MASCARENHAS | ISM |
| 2004 | RAHUL NANDKISHORE | JIS |

Cultural Convention 2005 Participants

| ISB | JIS | ISKL |
|--------------------|---------------------|-----------------|
| ADVISORS | ADVISORS | ADVISORS |
| Katherine Atkinson | Anne Andrews | Rick Bisset |
| Bob Connor | Bill Brown | Leslie Muri |
| Shawn Dubois | Lane Graciano | Karen Palko |
| Lisa Foran | Norman Ince | Susan Rahim |
| Jo Hanson | Amit Khanna | John Smith |
| Julie Puckett | Susan King-Lachance | Caroline Tan |
| Todd Puckett | Christine Perry | Grant Venables |
| Kelly Wadlegger | | Mark Webber |

PARTICIPANTS

| ISB | JIS | ISKL |
|--------------------|-------------------------|--------------------|
| Emily Angell | Mayesha Alam | Ileana Aguero |
| Anne Batra | Aaron Collett | Iva Aguero |
| Nina Bell | Ben Davies | Angela Bisset |
| Aaron Botwick | Kelly Flaten | Emma Blackmore |
| Tim Das | Fernanda Fukamati | George Bull |
| Jennifer Dickerson | Steven Hodgson | Katie Groom |
| Cecilia Eklund | Mariko Ikeda | Tanvi Gupta |
| Tanja Ferner | Tomas Landes | Laika Jumabhoy |
| Rizwan Hashim | Nicole Lee | Kyle Kozman |
| Paul Heath | David Marcou | Alison Lewis |
| Manami Jitsukawa | Nikolas Mitchell | Lisa Lim |
| Rashmi Kwatra | Sebastian Modak | Shirin Lim |
| Abyan Lokman | Paola Modesto | Looi Yi Wen |
| Lizzie Minges | Heather Mowatt | Troy Marschang |
| Sophia Parra | Shirelle Noble | Ben Martinez |
| Damon Porter | Maria Pantoja | Lauren Meany |
| Ploy Preugpaibul # | Omar Pardesi | Rukshan Mehra |
| Nithya Ratnayake | Eleena P'ng | Shiraz Mehra |
| Lisa Roolant | Kevin Potter | Jasin Nazim |
| Cod Satrusayang | Stephanie Ribbe | Amrietha Nellan |
| Kerrie Schroeder | Steven Rosa | Divya Nigam |
| Niki Schur-Narula | Mariam Sarwar | Chris Piech |
| Heather Sherfey | Aileen Sudarwo | Sher Rush |
| Matt Stefaniuk | Christina Teasdale | Miranti Setyari |
| Pira Sukhontarug | Michelle Turisno-Merill | Melissa Swaringen |
| Tan Tananivit | Tyler Wallace | David Tan |
| Maia Usui | James Wendt | Rebecca Thomas |
| Christine Wehrli | Trisha Winata | Danielle Verlinden |
| Kristin Weir # | | |
| Gary Yarbrough | | |

denotes 4 year IASAS Cultural Convention participant

| ISM |
|-----------------|
| ADVISORS |
| Yek Barlongay |
| Yvonne Cross |
| Mark Leuders |
| Gail Matheson |
| Solita Monsod |
| John Mulhall |
| Dan Skimin |
| |
| |
| |

| SAS |
|------------------|
| ADVISORS |
| Jim Baker |
| Bob Dodge |
| Ann Gould |
| Jeri Kett |
| Paul Koebnick |
| Trish Kuester |
| Catherine Parent |
| Nanette Ruhter |
| Paula Silverman |
| Rick Silverman |

| TAS |
|-----------------|
| ADVISORS |
| Doug Bishop |
| DJ Condon |
| Deb Flemming |
| Wally Hobbs |
| Leon Maggio |
| Craig Ortner |
| Lynn Somers |
| |
| |
| |

PARTICIPANTS

| ISM |
|----------------------|
| Alexandra Adelman |
| Ambika Bushan |
| Miguel Cajipe |
| Javier Campos |
| Joy Chua |
| Cristina Cu |
| Alexander DeLeon |
| Shruti Dhanda |
| Natashya Drilon |
| James Forbes |
| Gabriel Galea |
| Natashya Gutierrez |
| James Hartley |
| Aileen Haugh |
| Lauren Henry |
| Aiko Ishikawa |
| Yumiko Kunitani |
| Lee Marshall |
| Suvayu Pant |
| Paula Plaza |
| Shyama Rajendran |
| Paolo Servado |
| Aimee Sison |
| Soraya Soemadiredja |
| Claudia Squillantini |
| Jae Hee Suh |
| Ji Soo Suh |
| Priya Wad |
| |
| |
| |

| SAS |
|------------------|
| Ethan Bates |
| Richard Bates |
| Penn Bullock |
| Erich Bussing |
| Olivia Cain |
| Priyanka Dev |
| Deepti Dhir |
| Marisa Hale |
| Erin Han # |
| Olivia Kelly |
| Lexi Kirwin |
| Julia Knight |
| Nick Kreston |
| Tiffany Lin |
| Lucian Mattison |
| Sean McCabe |
| Emily Murray |
| Michaela Nilsson |
| Simi Oberoi |
| Will Reid |
| Cordelia Ross |
| Ang-Jun Seow |
| Sam Stonefield |
| Kathleen Sun |
| Tiffany Too |
| Wera von Wulfen |
| |
| |
| |

| TAS |
|---------------------|
| Chris Alison |
| Kim Chang |
| Dan Chen |
| Jennifer Chen |
| Kimberly Chen |
| Yo-Jud Cheng |
| Dan Chinoy |
| Crystal Chou |
| Meghana Chugani |
| Baye Shan Cooper |
| Sophie Darling |
| Jay Gokhale |
| Melody Hsu |
| Chris Huang |
| Jeff Jeng |
| Winston Kung |
| Rafael Laidlaw-Bale |
| Jenny Lee |
| Mei Li |
| Lauren Sefrin |
| Jason Shih |
| Ramin Shokrizadeh |
| Isaac Six |
| Mark Slack |
| Tom Tsai |
| Steven Ueng |
| Esther Veronin # |
| Esther Wang |
| Sagebelle Wu |
| Stephanie Wu |

denotes 4 year IASAS Cultural Convention participant

CULTURAL CONVENTION 2005 - DANCE

| THURSDAY - MARCH 10, 2005 | | | |
|---|--|-------------------------|--------------------|
| TIME | ACTIVITY | LENGTH | LOCATION |
| 7:30 - 8:00 | Opening Ceremonies | 0:30 | Auditorium |
| 8:15 - 10:00 | Dance Workshop - 1 Cheryl Quek - MODERN | 1:45 | Th. Studio |
| 8:15 - 9:55 | Tech Programming JIS/ISB/ISM/ISKL/TAS | 1:40 20 minutes each | Auditorium |
| 10:15 - 11:30 | ISB Dance Prep ISKL Dance Prep | 1:15 1:15 | Th. Studio S200 |
| 11:30 - 12:45 | TAS Dance Prep SAS Dance Prep | 1:15 1:15 | Th. Studio S200 |
| 11:30 - 12:30 | ISB Tech Rehearsal | 1:00 | Auditorium |
| 1:00 - 1:20 | SAS Dance Performance | 0:20 | Auditorium |
| 1:35 - 2:20 | JIS Drama Performance | 0:45 | Auditorium |
| 2:35 - 2:55 | ISB Dance Performance | 0:20 | Auditorium |
| 3:15 - 4:30 | Dance Workshop - 2 Lionel Araya - JAZZ | 1:15 | Th. Studio |
| 4:30 - 5:30 | ISKL Tech Rehearsal | 1:00 | Auditorium |
| 4:30 - 5:30 | ISM Dance Prep JIS Dance Prep | 1:00 1:00 | Th. Studio S200 |
| 5:30 - 6:45 | ISKL Dance Prep | 1:15 | Th. Studio |
| 7:15 - 8:00 | ISM Drama Performance | 0:45 | Auditorium |
| 8:15 - 8:35 | ISKL Dance Performance | 0:20 | Auditorium |
| 8:50 - 9:35 | TAS Drama Performance | 0:45 | Auditorium |
| CURFEW | | | |
| one hour after last event is completed | | | |

| FRIDAY - MARCH 11, 2005 | | | |
|---|---|-------------------------|--------------------------|
| TIME | ACTIVITY | LENGTH | LOCATION |
| 7:30 - 8:45 | Dance Critique | 1:15 | Th. Studio |
| 8:30 - 10:10 | Tech Programming ISKL/TAS/ISB/ISM/JIS | 1:40 20 minutes each | Auditorium |
| 9:00 - 10:15 | Dance Workshop - 3 Lionel Araya - HIPHOP | 1:15 | Th. Studio |
| 10:15 - 11:30 | JIS Dance Prep TAS Dance Prep | 1:15 1:15 | Th. Studio S200 |
| 11:30 - 12:30 | TAS Tech Rehearsal ISM Dance Prep | 1:00 1:00 | Auditorium S200 |
| 12:30 - 1:30 | Dance Workshop - 4 Lionel Araya - SALSA | 1:00 | Th. Studio |
| 2:10 - 2:55 | ISKL Drama Performance | 0:45 | Auditorium |
| 3:10 - 3:30 | TAS Dance Performance | 0:20 | Auditorium |
| 3:45 - 4:30 | ISB Drama Performance | 0:45 | Auditorium |
| 5:00 - 6:00 | ISM Tech Rehearsal JIS Dance Prep | 1:00 1:00 | Auditorium Th. Studio |
| 6:00 - 7:00 | JIS Tech Rehearsal ISM Dance Prep | 1:00 1:00 | Auditorium Th. Studio |
| 7:30 - 7:50 | ISM Dance Performance | 0:20 | Auditorium |
| 8:05 - 8:50 | SAS Drama Performance | 0:45 | Auditorium |
| 9:05 - 9:25 | JIS Dance Performance | 0:20 | Auditorium |
| CURFEW | | | |
| one hour after last event is completed | | | |

| SATURDAY - MARCH 12, 2005 | | | |
|---------------------------|---|--------------|----------------------|
| TIME | ACTIVITY | LENGTH | LOCATION |
| 9:00 - 10:15 | Dance Critique | 1:15 | Th. Studio |
| 10:30 - 11:30 | Dance Workshop - 5 Catherine Parent - SWING Dance Advisor's Meeting | 1:00 1:00 | Th. Studio S104 |
| 11:45 - 12:45 | LUNCH BREAK | 1:00 | HS Cafeteria |
| 12:55 - 1:45 | Extemporaneous Finals | 0:55 | Drama Th. |
| 1:55 - 2:50 | Original Oratory Finals | 0:55 | Drama Th. |
| 3:00 - 4:05 | Debate Finals | 1:05 | Drama Th. |
| 4:15 - 5:05 | Impromptu Finals | 0:50 | Drama Th. |
| 5:15 - 6:05 | Oral Interpretation Finals | 0:50 | Drama Th. |
| 6:05 - 7:30 | DINNER Advisors Dinner/Meeting General Meeting followed by specific groups | 1:25 1:25 | HS Cafeteria H301 |
| 7:45 - 8:15 | Closing Ceremonies | 0:30 | Auditorium |
| CURFEW 10:00PM | | | |

CULTURAL CONVENTION 2005 - DRAMA

| THURSDAY - MARCH 10, 2005 | | | |
|---|------------------------|-----------------|------------|
| TIME | ACTIVITY | LENGTH | LOCATION |
| 7:30 - 8:00 | Opening Ceremonies | 0:30 | Auditorium |
| 8:15 - 9:45 | Drama Workshop - 1 | 1:30 | Drama Th. |
| 8:15 - 9:55 | Tech Programming | 1:40 | Auditorium |
| | JIS/ISB/ISM/ISKL/TAS | 20 minutes each | |
| 10:15 - 11:30 | JIS Tech Rehearsal | 1:15 | Auditorium |
| | ISB Drama Prep | 1:15 | Drama Th. |
| | ISM Drama Prep | 1:15 | S105 |
| 11:30 - 12:45 | JIS Drama Prep | 1:15 | Drama Th. |
| | TAS Drama Prep | 1:15 | S105 |
| 1:00 - 1:20 | SAS Dance Performance | 0:20 | Auditorium |
| 1:35 - 2:20 | JIS Drama Performance | 0:45 | Auditorium |
| 2:35 - 2:55 | ISB Dance Performance | 0:20 | Auditorium |
| 3:15 - 4:30 | ISM Tech Rehearsal | 1:15 | Auditorium |
| | TAS Drama Prep | 1:15 | Drama Th. |
| | ISKL Drama Prep | 1:15 | S105 |
| 4:30 - 5:45 | ISM Drama Prep | 1:15 | Drama Th. |
| | SAS Drama Prep | 1:15 | S105 |
| 5:30 - 6:45 | TAS Tech Rehearsal | 1:15 | Auditorium |
| 7:15 - 8:00 | ISM Drama Performance | 0:45 | Auditorium |
| 8:15 - 8:35 | ISKL Dance Performance | 0:20 | Auditorium |
| 8:50 - 9:35 | TAS Drama Performance | 0:45 | Auditorium |
| CURFEW | | | |
| one hour after last event is completed | | | |

| FRIDAY - MARCH 11, 2005 | | | |
|---|------------------------|-----------------|------------|
| TIME | ACTIVITY | LENGTH | LOCATION |
| 8:30 - 10:00 | Drama Critique | 1:30 | Drama Th. |
| 8:30 - 10:10 | Tech Programming | 1:40 | Auditorium |
| | ISKL/TAS/ISB/ISM/JIS | 20 minutes each | |
| 10:15 - 11:30 | ISKL Tech Rehearsal | 1:15 | Auditorium |
| | ISB Drama Prep | 1:15 | Drama Th. |
| | SAS Drama Prep | 1:15 | S105 |
| 11:30 - 12:30 | ISKL Drama Prep | 1:00 | Drama Th. |
| | ISB Drama Prep | 1:00 | S105 |
| 12:30 - 1:45 | ISB Tech Rehearsal | 1:15 | Auditorium |
| | SAS Drama Prep | 1:15 | Drama Th. |
| | ISKL Drama Prep | 1:15 | S105 |
| 2:10 - 2:55 | ISKL Drama Performance | 0:45 | Auditorium |
| 3:10 - 3:30 | TAS Dance Performance | 0:20 | Auditorium |
| 3:45 - 4:30 | ISB Drama Performance | 0:45 | Auditorium |
| 5:00 - 6:30 | Drama Workshop - 2 | 1:30 | Drama Th. |
| 7:30 - 7:50 | ISM Dance Performance | 0:20 | Auditorium |
| 8:05 - 8:50 | SAS Drama Performance | 0:45 | Auditorium |
| 9:05 - 9:25 | JIS Dance Performance | 0:20 | Auditorium |
| | | | |
| | | | |
| | | | |
| | | | |
| | | | |
| | | | |
| | | | |
| CURFEW | | | |
| one hour after last event is completed | | | |

| SATURDAY - MARCH 12, 2005 | | | |
|---------------------------|---|--------|--------------|
| TIME | ACTIVITY | LENGTH | LOCATION |
| 9:00 - 10:30 | Drama Critique | 1:30 | Drama Th. |
| 10:30 - 11:30 | Drama Workshop - 3 | 1:00 | Drama Th. |
| | Drama Advisor's Meeting | 1:00 | S105 |
| 11:45 - 12:45 | LUNCH BREAK | 1:00 | HS Cafeteria |
| 12:55 - 1:45 | Extemporaneous Finals | 0:55 | Drama Th. |
| 1:55 - 2:50 | Original Oratory Finals | 0:55 | Drama Th. |
| 3:00 - 4:05 | Debate Finals | 1:05 | Drama Th. |
| 4:15 - 5:05 | Impromptu Finals | 0:50 | Drama Th. |
| 5:15 - 6:05 | Oral Interpretation Finals | 0:50 | Drama Th. |
| 6:05 - 7:30 | DINNER | 1:25 | HS Cafeteria |
| | Advisors' Meeting | 1:25 | H301 |
| | General Meeting followed by specific groups | | |
| 7:45 - 8:15 | Closing Ceremonies | 0:30 | Auditorium |
| | | | |
| | | | |
| | | | |
| | | | |
| | | | |
| | | | |
| | | | |
| | | | |
| | | | |
| | | | |
| | | | |
| | | | |
| CURFEW 10:00PM | | | |

CULTURAL CONVENTION 2005 - DEBATE & FORENSICS

| THURSDAY - MARCH 10, 2005 | | | |
|---|-------------------------|--------|-------------|
| TIME | ACTIVITY | LENGTH | LOCATION |
| 7:30 - 8:00 | Opening Ceremonies | 0:30 | Auditorium |
| 8:15 - 9:20 | Debate - 1 | 1:05 | H325 - H330 |
| 9:15 | Extemporaneous Prep | 0:30 | H212 |
| 9:45 - 10:45 | Extemporaneous - 1 | 1:00 | H325 - H327 |
| | Original Oratory - 1 | | H328 - H330 |
| 11:30 - 12:30 | Impromptu - 1 | 1:00 | H325 - H327 |
| | Oral Interpretation - 1 | | H328 - H330 |
| 1:00 - 1:20 | SAS Dance Performance | 0:20 | Auditorium |
| 1:35 - 2:20 | JIS Drama Performance | 0:45 | Auditorium |
| 2:35 - 2:55 | ISB Dance Performance | 0:20 | Auditorium |
| 3:15 - 4:20 | Debate - 2 | 1:05 | H325 - H330 |
| 4:30 - 5:20 | Impromptu - 2 | 0:50 | H325 - H327 |
| | Oral Interpretation - 2 | | H328 - H330 |
| 5:30 - 6:35 | Debate - 3 | 1:05 | H325 - H330 |
| 7:15 - 8:00 | ISM Drama Performance | 0:45 | Auditorium |
| 8:15 - 8:35 | ISKL Dance Performance | 0:20 | Auditorium |
| 8:50 - 9:35 | TAS Drama Performance | 0:45 | Auditorium |
| CURFEW | | | |
| one hour after last event is completed | | | |

| FRIDAY - MARCH 11, 2005 | | | |
|---|-------------------------|--------|-------------|
| TIME | ACTIVITY | LENGTH | LOCATION |
| 7:45 - 8:45 | Impromptu - 3 | 1:00 | H325 - H327 |
| | Oral Interpretation - 3 | | H328 - H330 |
| 9:00 | Extemporaneous Prep | 0:30 | H212 |
| 9:30 - 10:30 | Extemporaneous - 2 | 1:00 | H325 - H327 |
| | Original Oratory - 2 | | H328 - H330 |
| 11:15 - 12:20 | Debate - 4 | 1:05 | H325 - H330 |
| 2:10 - 2:55 | ISKL Drama Performance | 0:45 | Auditorium |
| 3:10 - 3:30 | TAS Dance Performance | 0:20 | Auditorium |
| 3:45 - 4:30 | ISB Drama Performance | 0:45 | Auditorium |
| 4:40 - 5:45 | Debate - 5 | 1:05 | H325 - H330 |
| 5:20 | Extemporaneous Prep | 0:30 | H212 |
| 5:50 - 6:40 | Extemporaneous - 3 | 0:50 | H325 - H327 |
| | Original Oratory - 3 | | H328 - H330 |
| 7:30 - 7:50 | ISM Dance Performance | 0:20 | Auditorium |
| 8:05 - 8:50 | SAS Drama Performance | 0:45 | Auditorium |
| 9:05 - 9:25 | JIS Dance Performance | 0:20 | Auditorium |
| CURFEW | | | |
| one hour after last event is completed | | | |

| SATURDAY - MARCH 12, 2005 | | | |
|---------------------------|---|--------|--------------|
| TIME | ACTIVITY | LENGTH | LOCATION |
| 10:30 - 11:35 | Debate Semi-Finals | 1:05 | H329 - H330 |
| 12:20 | Extemporaneous Prep | 0:30 | H212 |
| 11:45 - 12:45 | LUNCH BREAK | 1:00 | HS Cafeteria |
| 12:55 - 1:45 | Extemporaneous Finals | 0:55 | Drama Th. |
| 1:55 - 2:50 | Original Oratory Finals | 0:55 | Drama Th. |
| 3:00 - 4:05 | Debate Finals | 1:05 | Drama Th. |
| 4:15 - 5:05 | Impromptu Finals | 0:50 | Drama Th. |
| 5:15 - 6:05 | Oral Interpretation Finals | 0:50 | Drama Th. |
| 6:05 - 7:30 | DINNER | 1:25 | HS Cafeteria |
| | Advisors' Meeting | 1:25 | H301 |
| | General Meeting followed by specific groups | | |
| 7:45 - 8:15 | Closing Ceremonies | 0:30 | Auditorium |
| CURFEW 10:00PM | | | |

CULTURAL CONVENTION 2005 - TECHNICAL STUDENT SCHEDULE

| THURSDAY - MARCH 10, 2005 | | | | |
|---|--------------------------------|-----------|------------|--|
| TIME | ACTIVITY | LENGTH | LOCATION | |
| 7:30 - 8:00 | Opening Ceremonies | 0:30 | Auditorium | |
| 0:15 | | | | |
| 8:15 - 9:55 | Tech Programming | 1:40 | Auditorium | |
| | Workshop JIS/ISB//ISM/ISKL/TAS | | | |
| 0:20 | | 0:20 each | | |
| 10:15 - 11:30 | JIS Drama Tech Rehearsal | 1:15 | Auditorium | |
| 0:00 | (ISM) | | | |
| 11:30 - 12:30 | ISB Dance Tech Rehearsal | 1:00 | Auditorium | |
| 0:30 | (TAS) | | | |
| 1:00 - 1:20 | SAS Dance Performance | 0:20 | Auditorium | |
| 0:15 | | | | |
| 1:35 - 2:20 | JIS Drama Performance | 0:45 | Auditorium | |
| 0:15 | (ISM) | | | |
| 2:35 - 2:55 | ISB Dance Performance | 0:20 | Auditorium | |
| 0:20 | (TAS) | | | |
| 3:15 - 4:30 | ISM Drama Tech Rehearsal | 1:15 | Auditorium | |
| 0:00 | (ISB) | | | |
| 4:30 - 5:30 | ISKL Dance Tech Rehearsal | 1:00 | Auditorium | |
| 0:00 | (JIS) | | | |
| 5:30 - 6:45 | TAS Drama Tech Rehearsal | 1:15 | Auditorium | |
| 0:30 | (ISKL) | | | |
| 7:15 - 8:00 | ISM Drama Performance | 0:45 | Auditorium | |
| 0:15 | (ISB) | | | |
| 8:15 - 8:35 | ISKL Dance Performance | 0:20 | Auditorium | |
| 0:15 | (JIS) | | | |
| 8:50 - 9:35 | TAS Drama Performance | 0:45 | Auditorium | |
| | (ISKL) | | | |
| 9:35 - 9:50 | Strike | 0:15 | Auditorium | |
| CURFEW | | | | |
| one hour after last event is completed | | | | |

| FRIDAY - MARCH 11, 2005 | | | | |
|---|-------------------------------|--------|------------|--|
| TIME | ACTIVITY | LENGTH | LOCATION | |
| 7:30 - 8:00 | Tech - Fly Hangs | 1:00 | Auditorium | |
| 0:00 | | | | |
| 8:30 - 10:10 | Tech Programming | 1:40 | Auditorium | |
| | Workshop ISKL/TAS/ISB/ISM/JIS | | | |
| 0:05 | | | | |
| 10:15 - 11:30 | ISKL Drama Tech Rehearsal | 1:15 | Auditorium | |
| 0:00 | (JIS) | | | |
| 11:30 - 12:30 | TAS Dance Tech Rehearsal | 1:00 | Auditorium | |
| 0:00 | (ISKL) | | | |
| 12:30 - 1:45 | ISB Drama Tech Rehearsal | 1:15 | Auditorium | |
| 0:25 | (TAS) | | | |
| 2:10 - 2:55 | ISKL Drama Performance | 0:45 | Auditorium | |
| 0:15 | (JIS) | | | |
| 3:10 - 3:30 | TAS Dance Performance | 0:20 | Auditorium | |
| 0:15 | (ISKL) | | | |
| 3:45 - 4:30 | ISB Drama Performance | 0:45 | Auditorium | |
| 0:30 | (TAS) | | | |
| 5:00 - 6:00 | ISM Dance Tech Rehearsal | 1:00 | Auditorium | |
| 0:00 | (ISB) | | | |
| 6:00 - 7:00 | JIS Dance Tech Rehearsal | 1:00 | Auditorium | |
| 0:30 | (ISM) | | | |
| 7:30 - 7:50 | ISM Dance Performance | 0:20 | Auditorium | |
| 0:15 | (ISB) | | | |
| 8:05 - 8:50 | SAS Drama Performance | 0:45 | Auditorium | |
| 0:15 | | | | |
| 9:05 - 9:25 | JIS Dance Performance | 0:20 | Auditorium | |
| | (ISM) | | | |
| 9:25 - 9:40 | Strike | 0:15 | Auditorium | |
| CURFEW | | | | |
| one hour after last event is completed | | | | |

| SATURDAY - MARCH 12, 2005 | | | | |
|---------------------------|---|--------|---------------|--|
| TIME | ACTIVITY | LENGTH | LOCATION | |
| 9:00 - 10:00 | Tech Lighting Workshop | 1:00 | Auditorium | |
| 0:00 | | | | |
| 10:00 - 11:00 | Tech Project Discussion | 1:00 | Foyer | |
| 0:00 | | | | |
| 11:00 - 11:30 | Tech Prop Pack-up | 0:30 | Auditorium | |
| 0:15 | | | | |
| 11:45 - 12:45 | LUNCH BREAK | 1:00 | HS Cafeteria | |
| | | | | |
| 12:55 - 1:45 | Extemporaneous Finals | 0:55 | Drama Theatre | |
| | | | | |
| 1:55 - 2:50 | Original Oratory Finals | 0:55 | Drama Theatre | |
| 0:10 | | | | |
| | | | | |
| 3:00 - 4:05 | Debate Finals | 1:05 | Drama Theatre | |
| 0:10 | | | | |
| | | | | |
| 4:15 - 5:05 | Impromptu Finals | 0:50 | Drama Theatre | |
| 0:10 | | | | |
| | | | | |
| 5:15 - 6:05 | Oral Interpretation Finals | 0:50 | Drama Theatre | |
| | | | | |
| 6:05 - 7:30 | Dinner - Participants | 1:25 | HS Cafeteria | |
| | Advisors' Meeting | 1:25 | H301 | |
| | General Meeting followed by specific groups | | | |
| | | | | |
| 7:45 - 8:15 | Closing Ceremonies | 0:30 | Auditorium | |
| | | | | |
| | | | | |
| | | | | |
| | | | | |
| | | | | |
| | | | | |
| | | | | |
| | | | | |
| CURFEW 10:00PM | | | | |

2nd Floor
S Building
Fine Arts

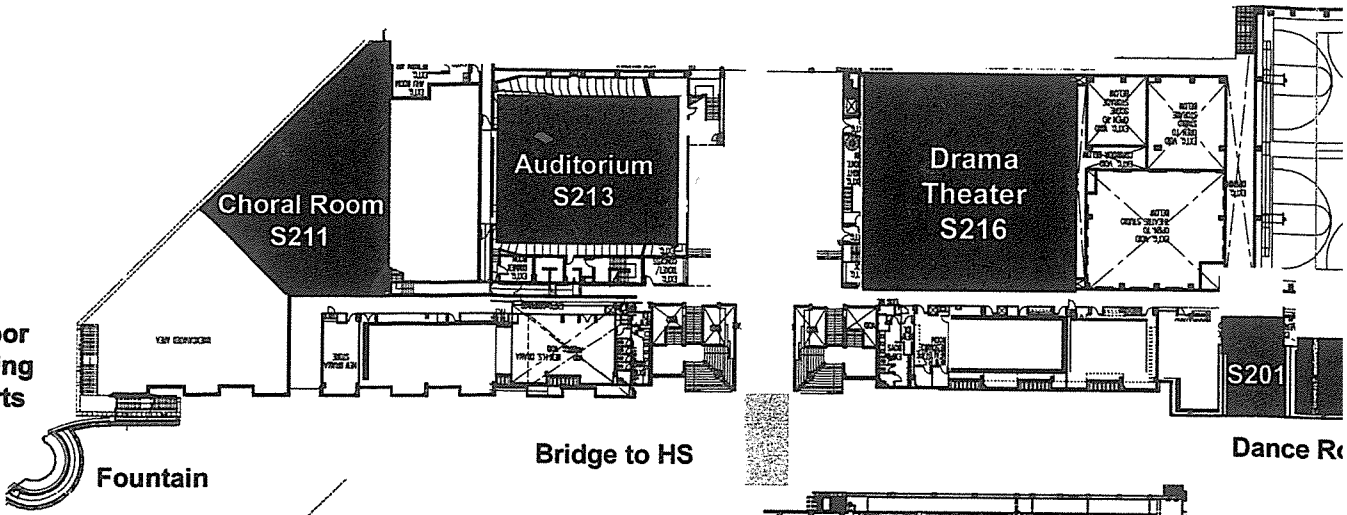

1st Floor
S Building
Fine Arts

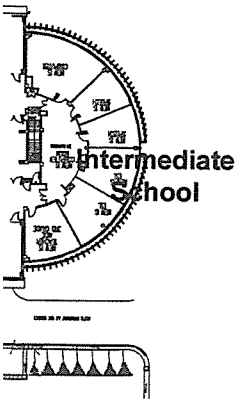
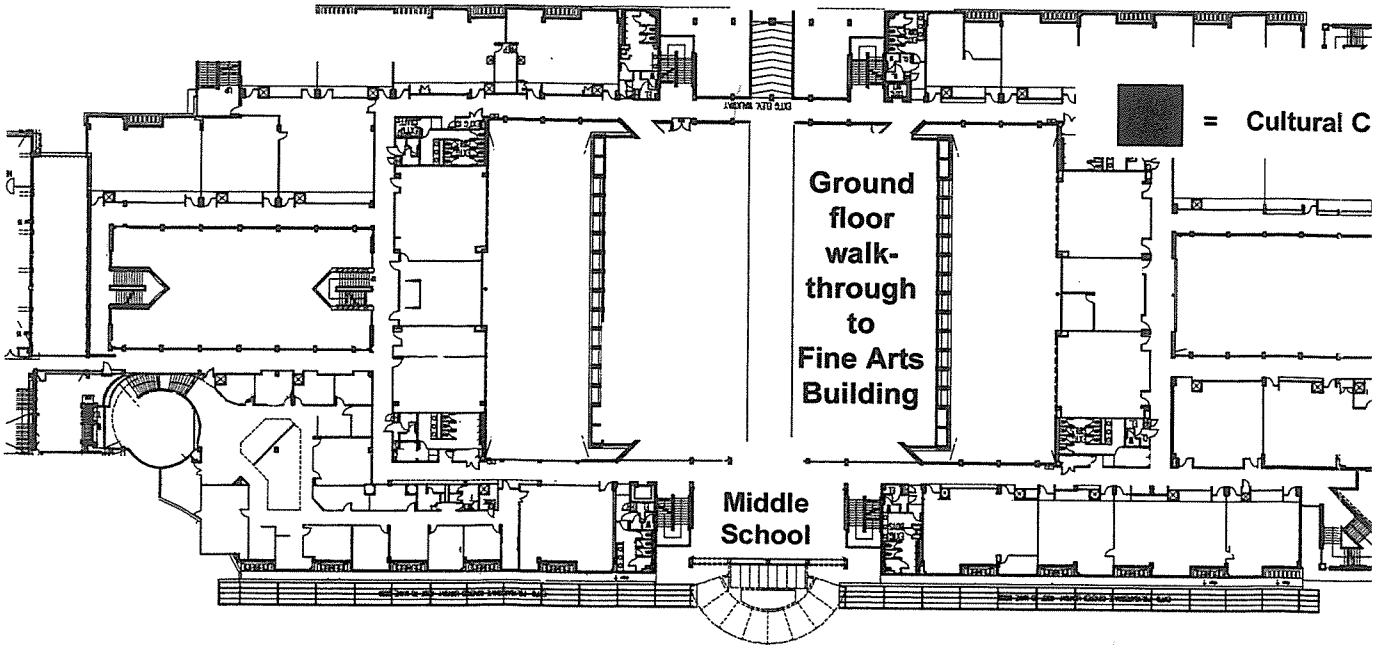
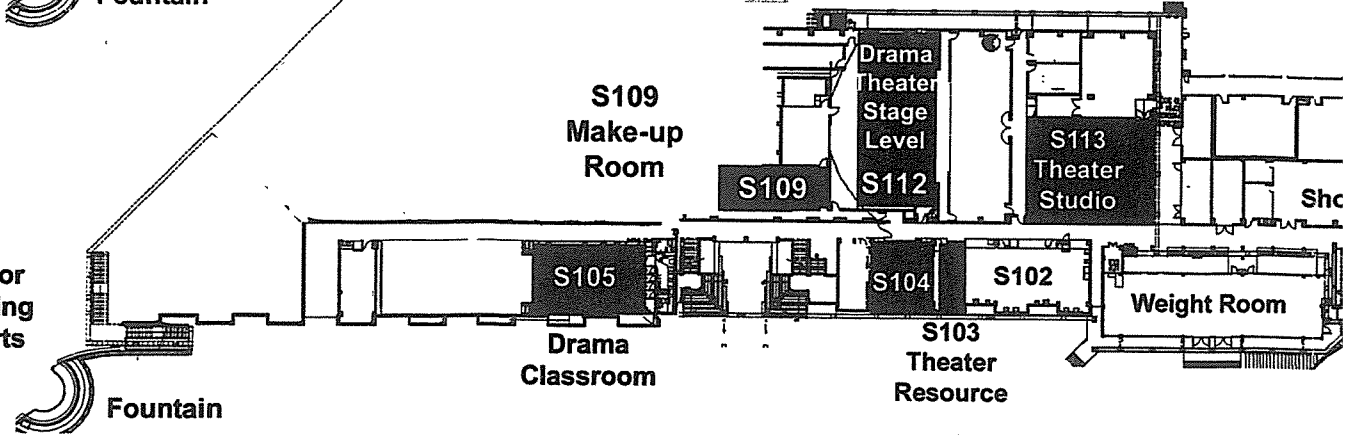

Cultural Conventions

Singapore American School Map

Main Gate

 = Cultural Convention Rooms

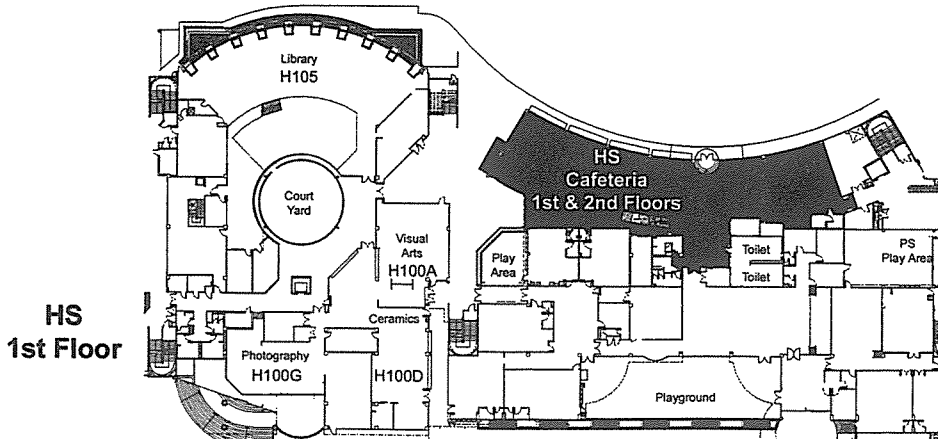
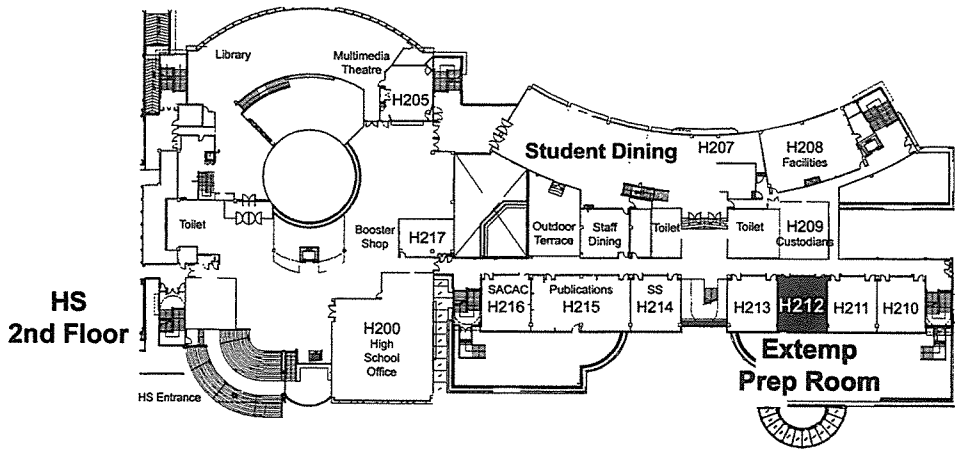
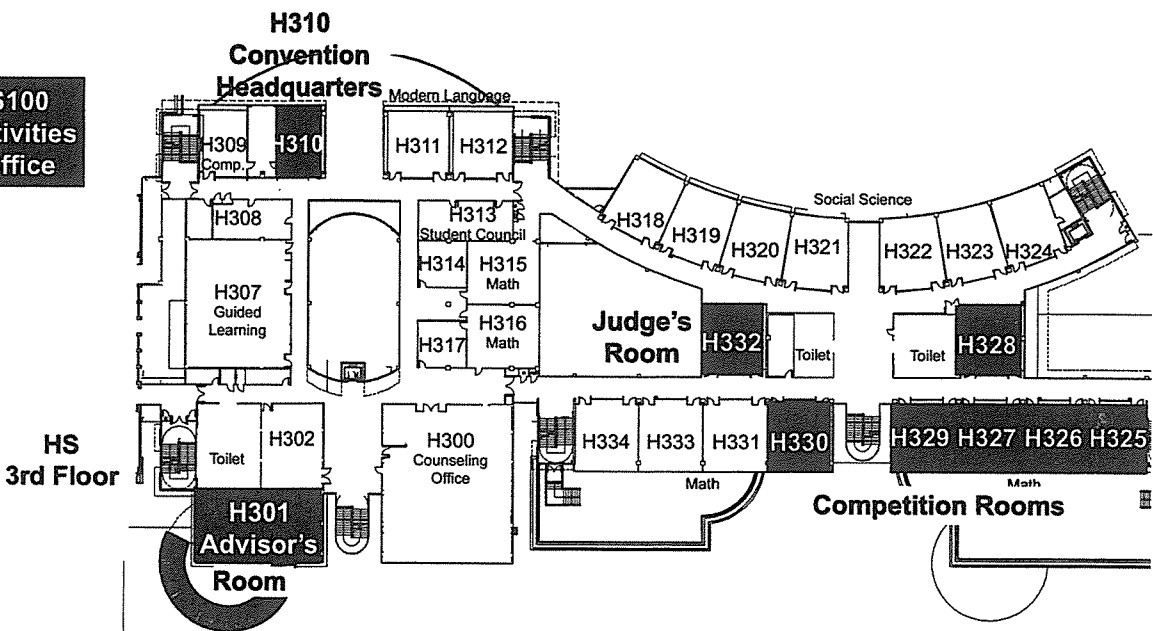
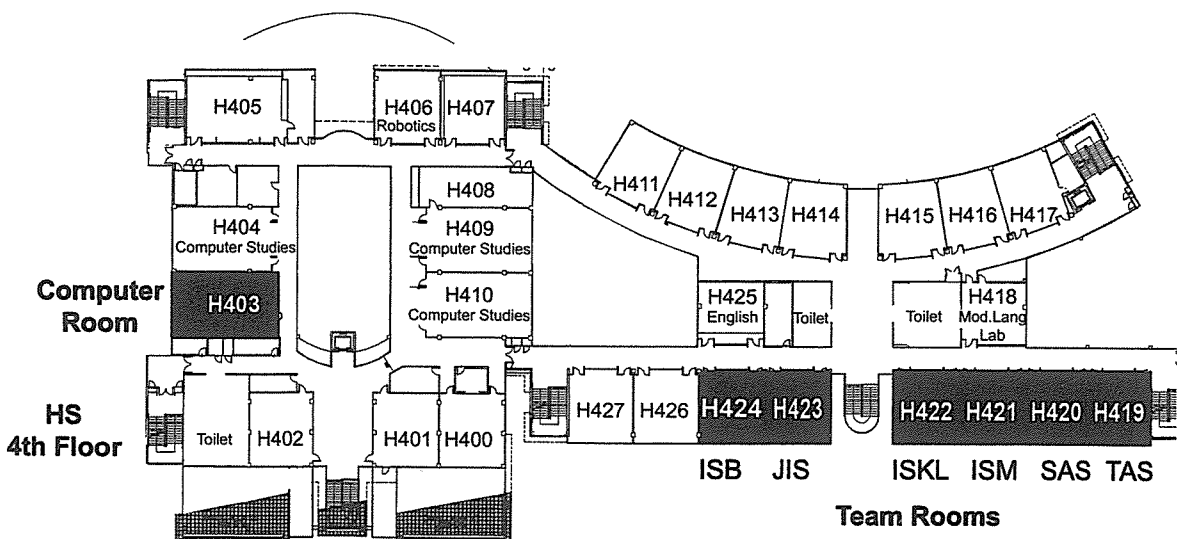
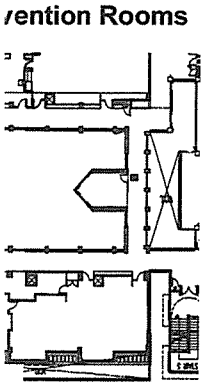
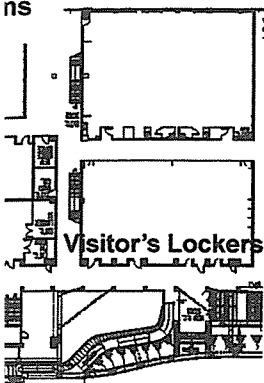
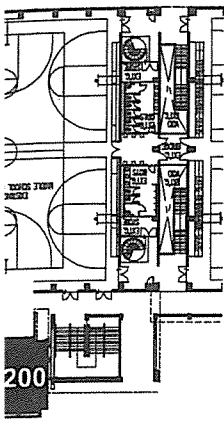

2005

JASAS Dance Workshop Director



LIONEL ARAYA (Artistic Director)

Lionel Araya has more than 15 years of experience as a choreographer, teacher, and an accomplished dancer. He was the Grand Champion of the 1997 International Street Dance Competition. His works include creating and performing dance sequences for CBS and Warner Bros (Hollywood, USA). Locally, he has showcased his works in Chingay 27, the Asian Tourism Awards 99, and the Singapore Radio Hit Music Awards 2000.

In the past five years, he has trained young aspiring dancers from MDC, SAF and individual talent groups, developing keen young dancers in Hip Hop/Funk, Street Jazz, Lyrical Jazz and Salsa.

Lionel's international accomplishments include organizing dance conventions in his native country, Costa Rica, and conducting his popular dance workshops in Manila, Bali, Chennai, and Singapore. He also participated in the 4th Annual West Coast Salsa Congress in Los Angeles (2002), the biggest and the most prestigious international salsa congress in the world, with participants from more than 40 countries, in which Lionel's choreography was voted one of the best choreographies from year 1999 to 2002.

CIRCUS

when I was 12 years old,
 My daddy took me to the circus
 ... The greatest ~~show~~ on Earth
 There were clowns and elephants and
 dancing bears and a beautiful lady in
 pink tights ~~that~~ ~~was~~ ~~above~~ ~~our~~ ~~heads~~
 And as I sat ~~there~~ watching,
 I had this feeling ~~missing~~ ~~was~~ ~~missing~~
 I don't know what
 But when it was all over
 I said to my
 Is that all there is to the circus?
 Is that all there is?

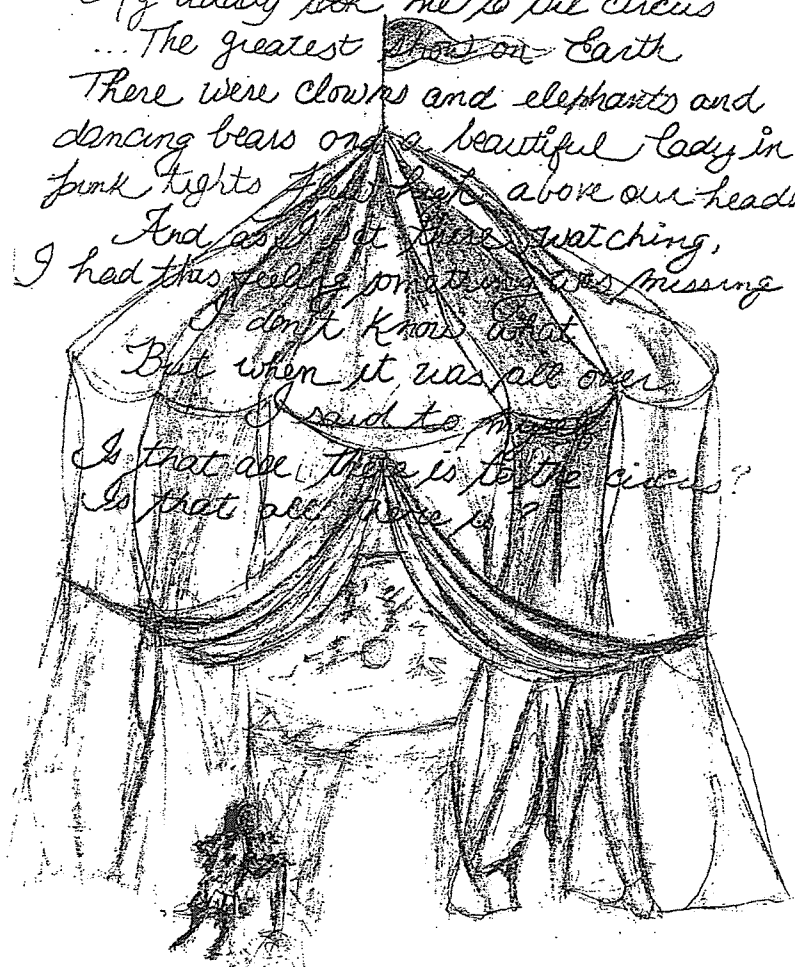

DANCERS

Olivia Cain
 Deepti Dhir
 Marisa Hale
 Olivia Kelly
 Emily Murray
 Michaela Nilsson
 Cordelia Ross
 Tiffany Too

ALTERNATES

Isabella Amstrup
 Shanna Iacovino

MUSIC

"Is That All There Is?"
 Circus Theme Music
 "Sneakin' out of the Hospital"
 "Episodes"
 "Summer '78"
 "J'y Suis Jamais Alle"
 "Boo"

Peggy Lee
 Traditional
 Beastie Boys
 Robert Ruggieri
 Yann Tiersen
 Yann Tiersen
 Pinback

CREDITS

Dance Directors:
 Choreographers:
 Lighting, Set, & Technical Advisers:
 Student Technician:
 Costume Design:

Mrs. Ann Gould, Ms. Catherine Parent
 The Dancers
 Ms. Barbara Harvey, Mr. Paul Koebnick, Mrs. Paula Silverman
 Erich Bussing
 Mrs. Kara Thoman, Mrs. Hong

Jakarta International School presents

Alcestis

By Euripides

Translated and adapted by Ted Hughes

*"The truth is it is the myths that are still out there waiting to wake us and be seen by us,
like a tree waiting to greet our newly opened eyes." Robert Calasso*

The Ensemble/Chorus:

Aaron Collett

Kelly Flaten

Fernanda Fukamati

Steven Hodgson

Nicole Lee

Nickolas Mitchell

Shirelle Noble

Bea Pantoja

Steven Rosa

Mariam Sarwar

James Wendt

The following step out of the chorus and play:

Apollo, god of music and medicine- Steven Hodgson

Death- The Ensemble

Alcestis, Queen of Thessaly- Fernanda Fukamati

Admetos, King of Thessaly- Nickolas Mitchell

Maid in the palace of Admetos- Kelly Flaten

Alcestis in her past and in death- Nicole Lee

Children of Admetos and Alcestis- Bea Pantoja, Aaron Collett

Heracles, son of Zeus- Steven Rosa

Pheres, father of Admetos- James Wendt, Mariam Sarwar

Chorus, advisor to Admetos- Nicole Lee

Servant Girls- Shirelle Noble, Bea Pantoja

Iolaus, attendant to Heracles- James Wendt

Lichas, attendant to Heracles- Aaron Collett

Directed by Susan King-Lachance and the Ensemble

Lighting Design- Kevin Potter

Alternates- Alexa Macdonald (Dramaturge), Natasha Schou, Dheepak

Chandramouli

**International School Bangkok
IASAS 2005 Dance Team
Presents**

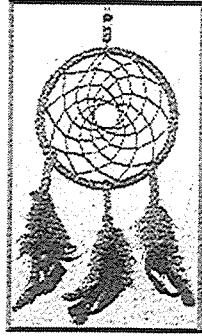

Could it be a dream...?

Performers: Nina Bell
Jennifer Dickerson
Sophia Parra
Ploy Preugpaibul
Nithya Ratnayake
Lisa Roolant
Kerrie Schroeder
Heather Sherfey

Alternates: Emi Lipscey-Magyar
Rapat Srikirin

Choreography: IASAS Dancers & Kelly Wadlegger
Costume Concept: Dancers
Costume Design: Khun Supanee
Lighting Design: Pira Sukhontarug
Technical Director: Shawn DuBois
Dance Director: Kelly Wadlegger

Synopsis:

We often find ourselves on the edge of illusion and reality; letting our dreams take us to unconfined distances. From the thousands of dreams we have in a lifetime varying from nightmares to ones of ultimate bliss, a few of these memorably stay with us. Our dance team used recollections of our own personal dreams as the inspiration to create the beginning of our dance. These dream ideas developed as we explored the difference between what is real and what is just a dream and the range of feelings that encompass both the realities and the dream state of mind.

- ♥ **“Solitude”** – Within ourselves the truth can often become distorted.
Music: Part 1 *Subway sounds* from Tokyo the City, The Sex Album
Part 2 *Vocals* by the dancers
Part 3 *Camilla* by Dudley, Jerzalik and Langa from the Complete Synthesizer Collection
- ♥ **“The Search”** – The detached state between dreaming and the real world, as we know it.
Music: *The Garden* by Faithless
- ♥ **“Ski...Kirai?” (Love...Hate in Japanese)** – The illusive simplicity of a flower can be a symbol for life. There is no rose without its thorns and even the most beautiful lotus flower can emerge from a puddle of mud.
Music: *It was all a Dream*, by Dream, Spider Fingers Music, Inc.
- ♥ **“If My Mind Would Just Stop Racing”** – Thoughts jumbling through one’s mind at the end of the day.
Music: *(title unknown)* by Apocalyptica from album Cult
- ♥ **“Rewind”** – Is a dream just the mind’s continuation of the day or is there a whole other dimension to it?
Music: *(title unknown)* track 6 from Café Del Mar, Volume Diez

THE CREATION OF MICHELANGELO

Devised by the ISM IASAS Drama Ensemble 2005

Michelangelo Buonarroti (1475 - 1564) was the genius behind the eternal sculptural masterpieces *David* and *La Pieta*. Sculpting was the love of his life. And yet, against his will, he was also made a painter: his magnificent Sistine Chapel ceiling fresco, commissioned by the forceful Pope Julius II, attests to this.

We took liberties with history in order to depict the essence of Michelangelo's rocky journey as an artist, from his boyhood to his completion of the Sistine ceiling in 1512. Our characters came alive from a stack of library books and improvisations, and wrote themselves into the pages of our script about an unwilling hero who was both creator and creature of fate.

| | |
|----------------------------|--|
| Miguel Cajipe | Teacher, Admirer, Horseman, Assistant |
| Nicanor Campos | Michelangelo |
| Alex de Leon | Boy Michelangelo, Assistant |
| James Forbes | Stonecutter, Pietro, Horseman, Admirer, Assistant |
| Gabriel Galea | Alberto the Model, Apprentice, Assistant |
| Ashley Gutierrez | Stonecutter, Admirer, Eugenio |
| James Hartley | Pope Julius II, Medici Worker, Admirer |
| Aileen Haugh | Wet Nurse, Admirer, Assistant |
| Lee Marshall | Contessina de Medici |
| Paolo Servado | Father, Medici Worker, Horseman, Assistant |
| Soraya Soemadiredja | Clara the Maid, Apprentice, Admirer |
| Yumiko Kunitani | Technical Director |
| Tami Monsod | Faculty Advisor |

The International School of Kuala Lumpur IASAS Dance presents:

Thing of Beauty

A thing of beauty is a joy for ever:
Its loveliness increases; it will never
Pass into nothingness; but still will keep
A bower quiet for us, and a sleep
Full of sweet dreams, and health, and quiet breathing.
Therefore, on every morrow, are we wreathing
A flowery band to bind us to the earth,
Spite of despondence, of the inhuman dearth
Of noble natures, of the gloomy days,
Of all the unhealthy and o'er-darkened ways
Made for our searching: yes, in spite of all,
Some shape of beauty moves away the pall
From our dark spirits.

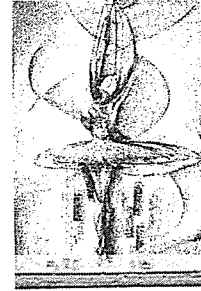

-John Keats

IASAS Dance Team

Ileana Aguero
Iva Aguero
Emma Blackmore
Lauren Meany
Divya Nigam
Miranti Setyari
Melissa Swaringen
Danielle Verlinden

Dance Director: Karen Palko
Student Technician: Katie Groom
Alternates: Chauncey Robinson, Val Tilos
Artwork: Rebecca Thomas
Costume Design: The Dancers
Choreography: The Dancers

Music Credits:
Music Box Dancer *by Frank Mills*
Nike Commercial
Holding On *by Ferry Costen (vocals by Shalley Harland)*
It Doesn't Matter Two Instrumentals *by Depeche Mode*
Fall Break *by Aim*
Love, Peace and Grease *by BT*
Who is Tyler Durdan *by the Dust Brothers*
The Perfect Lie *by the Engine Room*
Sometimes I Just Go For It *by the Used*

Thank you to Baker-Huges and Tioman Drilling for
sponsoring our show this year!

Simply Maria, or the American Dream

By Josefina Lopez (1996)

The Family:

| | |
|-----------------------------|--|
| ESTHER VERONIN: | Maria, the girl (+ Statue, Illegal Immigrant) |
| SAGEBELLE WU : | Carmen, the mother (+Illegal Immigrant, Horse) |
| ISAAC SIX : | Ricardo, the father (+ Horse, Referee, Baby Thrower) |
| RAFAEL LAIDLAW BALE: | Jose, the husband |

The Ensemble:

| | |
|-----------------------------|---|
| CHRISTOPHER ALISON: | Statue, Immigrant, Pervert, Horse, Priest, TV director, Reproducing Machine Salesman, Courtroom Judge |
| RAFAEL LAIDLAW BALE: | Village Priest, Immigrant, Gangsta, Uncle Sam, Commercial Husband, Bailiff |
| CRYSTAL CHOU: | Carmen's Mother, Gossiping Woman, Girl 2, Mexican immigrant, Mexican Maria, Valley Girl, Head Nurse, Courtroom Jury |
| MEGHANA CHUGANI: | Gossiping Woman, Girl 3, Immigrant, Protester, American Mary, TV Announcer, Baby Receiver, Courtroom Prosecuting Lawyer |
| STEPHANIE WU: | Gossiping Woman, Girl 1, Immigrant, Valley Girl, Myth Mary, Commercial Wife, Baby Deliverer, Courtroom Jury |

Alternates:

GARETH LIM & EUNICE PNG

Cameo Appearances:

| | |
|--------------------|-----------------------|
| GARETH LIM: | Soap Opera Man |
| EUNICE PNG: | Soap Opera Woman |
| MARK SLACK: | The Statue of Liberty |

Direction:

| | |
|--------------------------|-------------------------------------|
| RAMIN SHOKRIZADAH | Technical Director |
| PATRICIA SANDS | Production and Direction Assistance |
| DOUGLAS BISHOP | Direction |

SYNOPSIS

Mexican-American Josefina Lopez completed this script as a 17 year old in East L.A. In many ways, it is her own story of growing up and dealing with gender roles, cultural conflicts, generation gap, and the American Dream. It tells the story of Maria, a young Latina aspiring to be an actress and her dream of going to college. The story begins in Mexico with Maria's parents eloping. Maria is born and soon after they leave for the U.S. Her father Ricardo tells Maria that in America, with education, she can have the American Dream. Maria believes him; however, when she tells her parents she wants to go to college, they order her to get married instead. Maria is so upset she cries herself to sleep and has a nightmare...and later overhears a shocking conversation. In the end, she realizes she must go to college to have the life she wants, one that combines the best of her two worlds.

Production Rights granted by the Dramatic Publishing Company, Chicago, USA

15K L

IASAS DRAMA

A WOMAN IN MIND by Alan Ayckbourn

Cast list:

BillAngela Bisset
Gerald.....Kyle Kozman
Tony.....David Tan
Andy.....Rukshan Mehra
Rick.....Ben Martinez
Lucy.....Rebecca Thomas
Muriel.....Alison Lewis
Susan.....Sher Rush
Male Understudy.....Callum Meany
Lighting Designer and Technician.....Katie Groom
Costumer.....Donna Lyon
Director.....Mark Webber

This dark comedy by Alan Ayckbourn plays upon the question whether we have the ability to choose our own reality. It also touches on the human comedy in our inability when it comes to choosing our family. Susan, a housewife, struggles to decide her reality for better or for worse.

Taipei American School IASAS Dance 2005

DINNER AT EIGHT, DANCING TO FOLLOW

Even though we dress up for formal affairs, underneath we remain ourselves, with all our human quirks and eccentricities.

Music :

Edgar Meyer - 1B

Gioachino Rossini - La Gazza Ladra

Serge Prokofiev - Symphonie no. 1 in D major, Gavotta

William Walton - Façade

Johann Strauss, Jr. - Voices of Spring Waltz Op. 410

Leos Janacek - Tema con variazioni

J. S. Bach - Musette

Choreographers/Dancers:

Kim Chang, Kimberly Chen, Baye-Shan Cooper,

Sophie Darling, Chris Huang, Jenny Lee,

Lauren Sefrin, Tom Tsai

Choreographers/Alternates:

Michelle Fuang, Allyson Lai, Kai Lin Lau,

Jessica Liu, Jen Wang

Director:

Deborah Flemming

Music Advisor:

Stephen Abernethy

Costume Design: Amanda Darling

International School Bangkok
AN ENEMY of the PEOPLE

Henrik Ibsen

Adapted by Arthur Miller

In the forward to his adaptation Arthur Miller writes

'I have attempted to make **An Enemy of the People** as alive to Americans as it undoubtedly was to Norwegians... Its central theme is, in my opinion, the central theme of our social life. Simply, it is the question of whether the democratic guarantees protecting political minorities, ought to be set aside in time of crisis.'

At the centre of *Enemy* is a doctor who discovers an evil in his town – he naïvely believes that making the public aware of the issue will at least earn him gratitude. It is a shock, therefore, when he learns that the town wants to perpetuate the evil and force him to conform to their way of thinking. He maintains his commitment to speaking the truth and suffers the consequences. The play's idea that those who sacrifice the truth for ulterior motives eventually become corrupt themselves is relevant in many societies today.

Mayor Sonja Stockmann

Dr. Thomas Stockmann

Mrs. Stockmann

Petra Stockmann

Hovstad

Aslaksen

Billing

Captain Horster

Citizen Leaders

Citizens

Angry Mob

Technical Assistance

Director

Abyan Lokman

Kristin Weir

Tanja Ferner

Emily Angell

Paul Heath

Cecilia Eklund

Matt Stefaniuk

Gary Yarborough

Lizzie Minges, Christine Wehrli

Aaron Botwick, Ingrid Fleuren

Manami Jitsukawa

ISB Cultural Convention Delegates

Pira Sukhontarug, Shawn Dubois

Jo Hanson

Musical Excerpts:

Halvorsen: Danses Norvégiennes

Halvorsen: Air Norvégien, Op. 7

Grieg: Piano Concerto in A Minor Op. 16

Scenes 1 & 2:

Dr. Stockmann's house

Scene 3:

Editorial office of *The People's Daily Messenger*

Scene 4:

A room in Captain Horster's house

IASAS Cultural Convention 2005
ISM Dance Company
Synopsis

Once in a world of innocence and purity you enter a world of corruption, brimming with wide eyed naiveté. Simple beginnings of exploration into the evils of the world manifest into deeper and deeper despair, slowly moving away from your true self. It taints you. It pollutes you. In this world of blackness, you are bound, both to be trampled by evil. Once the apple of temptation blooms before you, giggling within your grasp you cannot resist. The glistening of evils unknown beckoning to your every sense until you are forced to succumb before it. But the sweetness that enthralled you burns bitter in your soul. Every bite eats away at your innocence, at your purity. Every bite draws you further from the world that you once knew. Frightened, panicked you find yourself in a frenzy attempting to free yourself. As hard as you try you can never return. The experience has transformed you and you will never reclaim your former self. You are trapped.

Song Title

I. Sanctus
II. Credo
III. Tetsujin

Composer

Ryan Cayabyab
Ryan Cayabyab
Don Davis

Dancers

Joy Chua, Cristina Cu, Natasha Drilon, Aiko Ishikawa, Paula Plaza, Aimee Sison, Claudia Squillantini, Priya Wad

Dance Choreography

IASAS Dance Team

Technical Director

Yumiko Kunitani

Dance Director

Yek Barlongay/Vinia Pamplona

CULTURAL CONVENTION D R A M A

S A S

Dinner

by Moira Buffini

Thick fog outside delivers up an odd assortment of characters – including a silent waiter sourced from an obscure website – as Paige, hostess extraordinaire, whips up a celebratory dinner to honor the publication of her husband’s best selling book.

An apocalyptic evening begins.....enjoy!

c a s t

PAIGE, the hostess.....ERIN HAN

LARS, the writer.....WILL REID

The WAITER.....WERA VON WULFEN

WYNNE, an artist.....TIFFANY LIN

HAL, a biologist.....SAM STONEFIELD

SIAN, a journalist.....LEXI KIRWIN

MIKE, an uninvited guest.....NICK KRESTON

Alternates: STEPHEN SAXTON, CHELSEA CURTO

director: Trisha Kuester

assistant director: Stephen Saxton

costumes: Susan Murray

technical assistants: Erich Bussing

Karthik Subramaniam

Christopher Yun

*Jakarta International School
Dance Synopsis*

There's a time for...

A fisherman rests after an unsuccessful haul. Does he dream, or has his memory transported him to a different plane?

Description of Scenes

- *In the depths – morning*
- *On the beach – afternoon*
- *Above and below water – evening*

JIS IASAS Dance Team

Mariko Ikeda

Fabian Klavert

Paola Modesto

Heather Mowatt

Eleena P'ng

Aileen Wong Sudarwo

Christina Teasdale

Trisha Winata

Advisor

Christine Perry

Composer:

Erik Satie

CULTURAL CONVENTION

MARCH 9-13, 2005

IASAS RULES & GUIDELINES

1. Use of possession of tobacco (including smokeless), alcohol, and/or drugs, flagrant curfew violations, violent behavior, violations of off-limits areas, cheating, deceit, as well as aiding and/or abetting in any of the listed offenses will not be permitted during any IASAS event or an SAS sponsored activity.
Penalties for infractions are as follows:
 - a. The student will be immediately suspended from further participation in the event.
 - b. The student will be sent home if feasible, at parents' expense.
 - c. The student will be excluded from all I.A.S.A.S. events or exchanges at SAS or at other I.A.S.A.S. schools for one full year from the date of infraction, including the same tournament/convention the following year.
 - d. The student will not be eligible to receive letters or awards for that activity. A violation will also preclude a student from receiving any other activity or athletic awards.
 - e. SAS reserves the right to apply additional disciplinary action.
2. Off-limits areas include any establishments that sell alcoholic beverages or areas of a city otherwise designated as off-limits by the host school.
3. Exploration of the local environment will not be permitted without the knowledge and consent of the host parent/guardian and trip administrator/coach.
4. Housing assignments may only be changed by a school's Athletic Director.
5. Daily curfews for all I.A.S.A.S. events or SAS sponsored activities will be determined by the host school. All tournament/convention participants (hosting or visiting) must return to the host family's house before the stated curfew each night. However, should an event finish later than one hour before the stated curfew, curfew will be extended until one hour after the conclusion of the event.
6. Coaches will telephone each student, each night at the curfew hour to ensure all students have returned home safely and on time. Once a student has reached home and answered the curfew call, he/she may not leave the house.
7. All laws of the host country must be observed. Guidelines are to be provided by host schools as required.
8. Any problems arising during the tournament/convention should be reported immediately to the host school for corrective measures.
9. All students are required to attend all events officially affiliated with the tournament/convention, including special evening events.
10. Student medical release forms will be available at the tournament/convention site each day of the event.
11. All students must carry their Tournament/Convention Identification Cards with them.
12. Each participant will follow the Travel Dress Code Policy as listed on page 65 of the Student Handbook and travel information sheet when traveling.
13. Participants will assist with housing when needed. Please see pages 64-65 of Student Handbook under Housing for Activities/Events.
14. Parental supervision is required on each night of the events.

"THANK YOU"

To

Everyone who has helped
put this 2005 IASAS Cultural
Convention together.

Good luck to International
School of Bangkok as they
prepare for the 2006
Convention.



Mimi Molchan
Convention Director

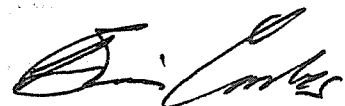

Brian Combes
Convention Director

NOTES

